



**PROJECT
HOMELESS
CONNECT
MILWAUKEE COUNTY**

**Marquette Alumni Memorial Union
1442 W. Wisconsin Ave., Milwaukee WI, 53233
Thursday, October 16th, 2014
10:00am - 3:00pm**
A Milwaukee Continuum of Care Event
www.milwaukeeecoc.org



EVENT OVERVIEW

- 8:30 AM – 9:00AM Service Provider, Resource Table, and Volunteer Registration – Alumni Union Level 2
- 9:15 AM Volunteer Orientation
- 9:45 AM Guest Intake Begins
- 10:00 AM - 10:15 AM Welcome/Event Overview – Weasler Auditorium –
Stephanie Russell, Marquette University Mission & Ministry Vice President
- Opening Speeches
- 1) City of Milwaukee – Mayor Tom Barrett
 - 2) Milwaukee County – County Supervisor Peggy Romo West
- 10:15 AM - 2:30 PM Project Homeless Connect: Service Provider & Resource Table Access – Alumni Union Levels 1-3
- 11:00 AM – 1:15 PM Lunch – Marquette Place – Level 2
- 2:30 PM Intake Ends
- 3:00 PM Event Ends

The Milwaukee Continuum of Care, as part of the 10 Year Plan to End Homelessness, is excited to present our fifth annual Project Homeless Connect!

A special thanks to everyone who was involved and helped to plan this event! Thank you to all of the agencies and service providers who agreed to come and share information, provide services, and desired to be a part of this event. Thanks to all of the volunteers who donated their time to participate in this event. Lastly, thank you to all of the guests who came to this event. We hope it was worth your time and helpful to you.



Job Fair Participants

- ❖ YWCA
- ❖ WRTP/BIG STEP
- ❖ Job Center of WI/Dept of Workforce Development
- ❖ Goodwill Industries of Southeast WI
- ❖ Job Corps
- ❖ Interfaith
- ❖ Marquette Career Services
- ❖ Wisconsin Community Services
- ❖ Labor Ready
- ❖ Walgreens
- ❖ TFC Bank

Service Provider Participants

- ❖ Be U Barber Shop
- ❖ Community Healthcare Access Program-Milwaukee Health Department
- ❖ Crystal Robinson Hair Design
- ❖ Dr. Darwin
- ❖ Front Room Photography
- ❖ Help-Portrait Milwaukee
- ❖ Impact 211
- ❖ Justice 2000
- ❖ Karen Thompson Hair Design
- ❖ Marquette Law School
- ❖ Marquette Neighborhood Health Center
- ❖ Marquette University -Chapel of the Holy Family
- ❖ Milwaukee Health Dept. HIV/STI Program
- ❖ Outreach Community Health Centers-PATH
- ❖ Phil Homan Barber Designs
- ❖ Repairers of the Breach
- ❖ Salon East
- ❖ Social Security Administration
- ❖ St. Elizabeth Ann Seton Dental Clinic
- ❖ St. Ben's
- ❖ Stephanie Kirsch – Blessing Bags
- ❖ Target Vision
- ❖ Walgreens
- ❖ WCS/Center for Driver's License Recovery & Employability Program
- ❖ Wheaton Franciscan Healthcare
- ❖ Wisconsin/Center for Driver's License Recovery



Resource Fair Participants

- ❖ Anthem Blue Cross Blue Shield
- ❖ Aids Resource Center of Wisconsin (ARCW)
- ❖ Aurora Family Services
- ❖ Aurora Walker's Point Community Clinic
- ❖ Automated Health Services
- ❖ Black Health Coalition
- ❖ Bureau of Child Welfare
- ❖ Catholic Charities
- ❖ City of MKE Health Dept - Immunization
- ❖ City of MKE Health Dept - STD/HIV
- ❖ City of MKE Health Dept - Men's Health
- ❖ City of MKE - Housing Authority
- ❖ Community Advocates
- ❖ Community Care
- ❖ Center for Veterans Issues
- ❖ CORE/EL Centro
- ❖ Disability Rights Wisconsin
- ❖ Diverse & Resilient
- ❖ Dry Hootch
- ❖ Grand Avenue Club
- ❖ Hope House of Milwaukee
- ❖ Hunger Task Force
- ❖ Hupy & Abraham SC
- ❖ IMPACT Alcohol and Drug Abuse Services
- ❖ Independence First
- ❖ Komen
- ❖ La Causa/Crisis Nursery
- ❖ Legal Action
- ❖ Managed Health Services
- ❖ Mercy Housing Lakefront/St. Catherine's Residence
- ❖ Mental Health America
- ❖ MKE County – Behavioral Health Division – Crisis Services
- ❖ MKE County - Community Access to Recovery Services
- ❖ MKE County - Dept. on Aging
- ❖ MKE County - Disability Services
- ❖ MKE County – Housing Division
- ❖ Milwaukee Health Services, Inc.
- ❖ Milwaukee Justice Center
- ❖ Milwaukee Public Library
- ❖ Molina Healthcare
- ❖ MKE Public Schools/Homeless Education Program
- ❖ My Home Your Home/Lissy's Place
- ❖ NAMI Greater Milwaukee
- ❖ Outreach Community Health Centers
- ❖ Owen's Place



- ❖ Pathfinders/Streetbeat
- ❖ Prevent Suicide Greater Milwaukee
- ❖ Progressive Community Health Centers
- ❖ Safe Families for Children
- ❖ Safelink/Cellphones
- ❖ Salvation Army
- ❖ Sojourner Family Peace Center
- ❖ SaintA's
- ❖ St. Ben's
- ❖ The Gathering/Open Door Café/St.Vincent de Paul
- ❖ TLS Crisis Resource Centers
- ❖ Trilogy Health Care
- ❖ United Healthcare Community Plan
- ❖ Veteran's Administration (VA)
- ❖ VA Regional Office
- ❖ Walker's Point Youth and Family Center
- ❖ WI Dept. of Health Services
- ❖ WIC
- ❖ WI Council on Problem Gambling
- ❖ YWCA
- ❖ The Gathering Meal Program



Room Assignments for Project Homeless Connect:

Level 1

157: Hygiene Kits & Snack Bags

163: Clothing Bank

Brooks Lounge/168: Sleeping Bags; break area

Level 2

227: Job Fair

228 & 230: PATH Outreach (serving people who are homeless w/ mental illness)

231: HIV/STI Testing

233: Justice 2000 Screening – Legal Assistance

252: Birth Certificates Assistance & other referrals

254: Blood Pressure/ Flu Shots: Walgreens & Wheaton Franciscan Healthcare

Wes Towne Lounge: Registration and Help Desk

Henke Lounge: Haircuts

Marquette Place: Lunch

Chapel of the Holy Family: Guided Meditation & Quiet Reflection

Level 3

Ballrooms A, B and E: Resource Fair

Ballroom C: Vision Screenings

Ballroom D: Dental Screenings

Lynch Lounge: Photographers, Milwaukee County – Housing, City of Milwaukee - Housing

305: Employment Workshops

362: IMPACT 211 – Information and referral, follow up appointments & bus tickets

364: WCS/Driver's License Recovery Program

368: Badgercare, FoodShare, Health Insurance, & Other Application Assistance

370: Social Security Benefits

374: Blood Pressure Screening, Vitals, and BMI testing: Marquette Neighborhood Health Center

380: Marquette Law School – Legal Consults

Questions?:

Project Homeless Connect lead volunteers dressed in BLACK t-shirts are stationed throughout the event to assist you with any questions or concerns you may have. If you are having difficulties, please see one of these volunteers. YELLOW shirted volunteers are familiar with Marquette and can help you locate rooms and facilities. You may also visit the registration table on level 2 at any time for assistance.

MAPS

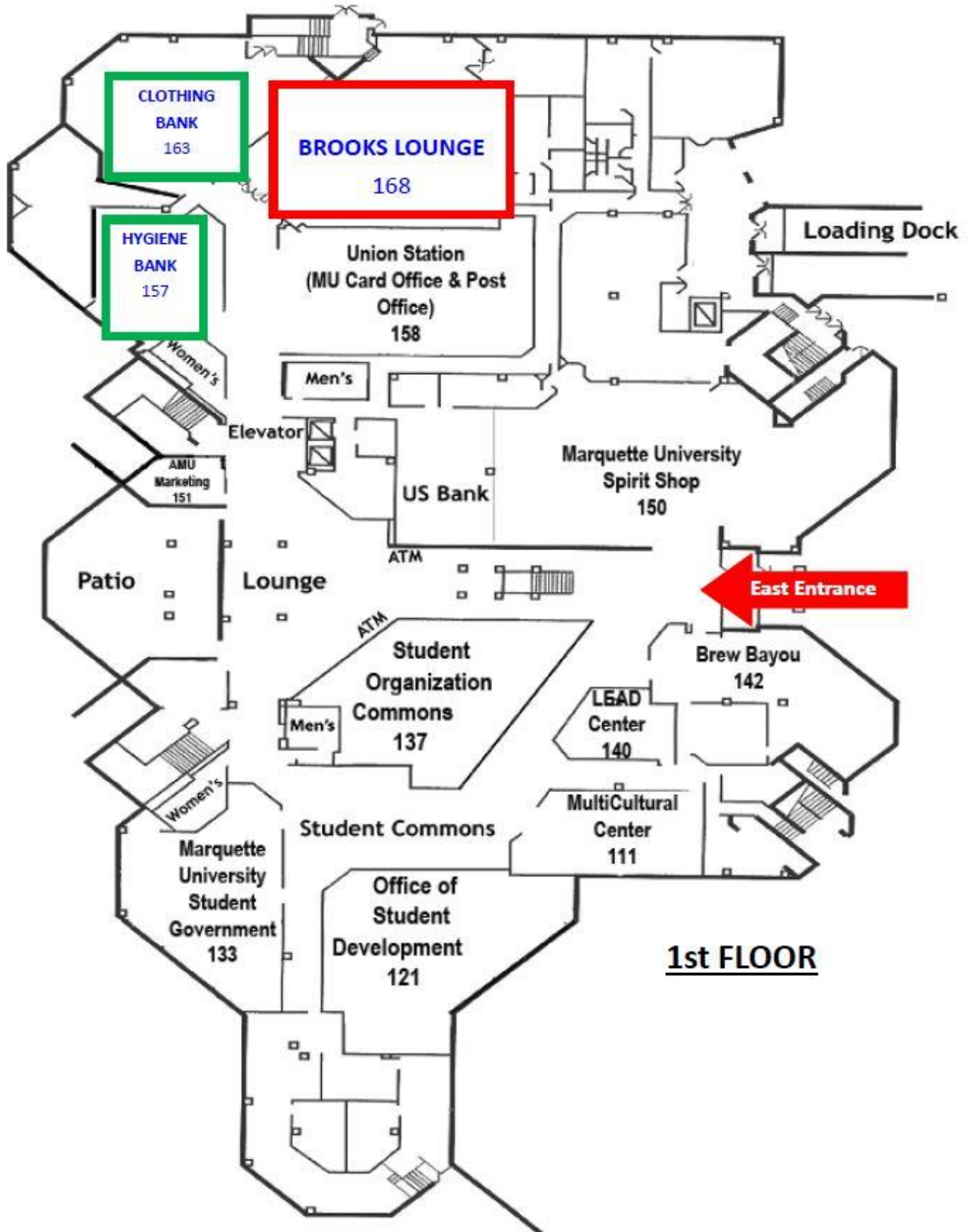

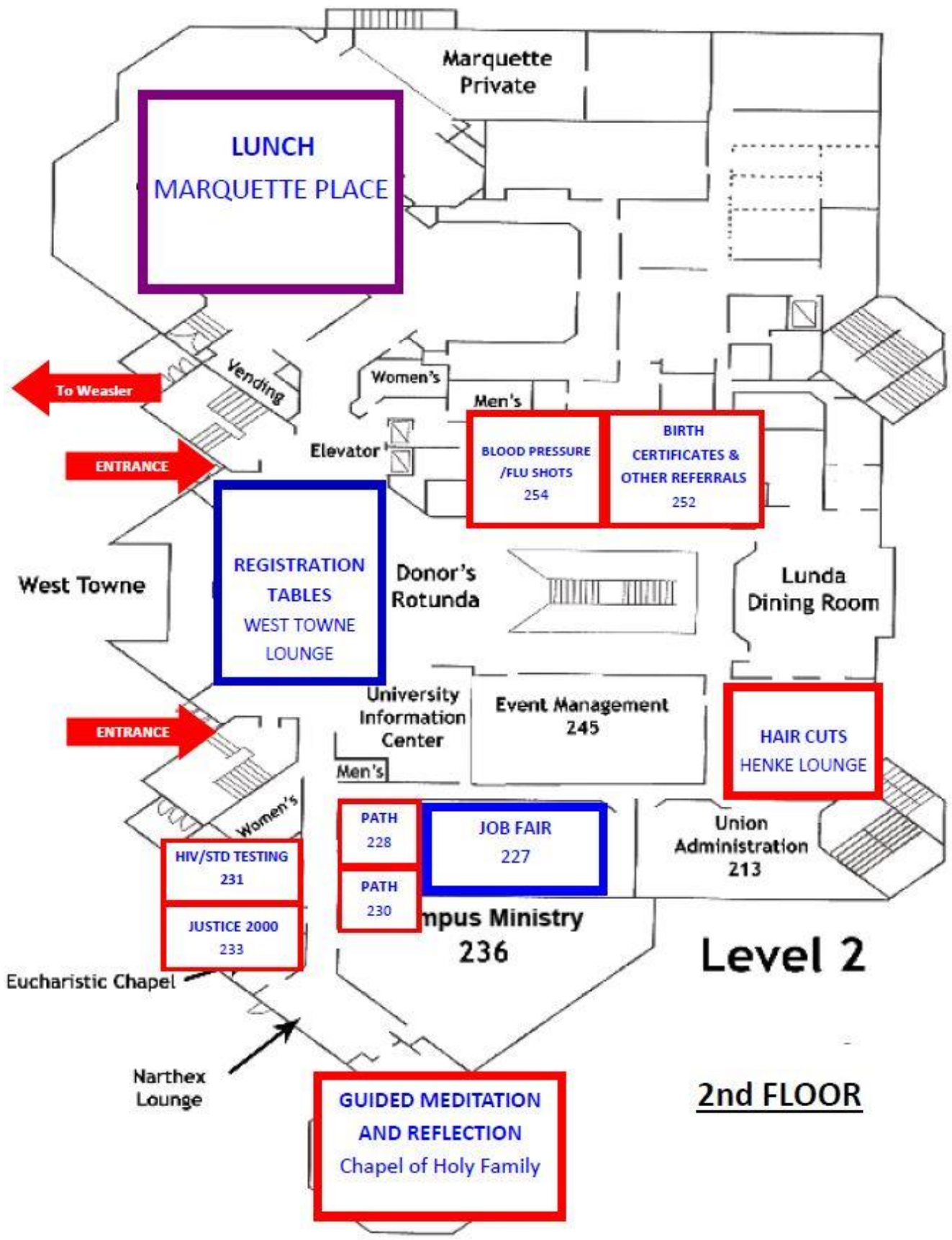

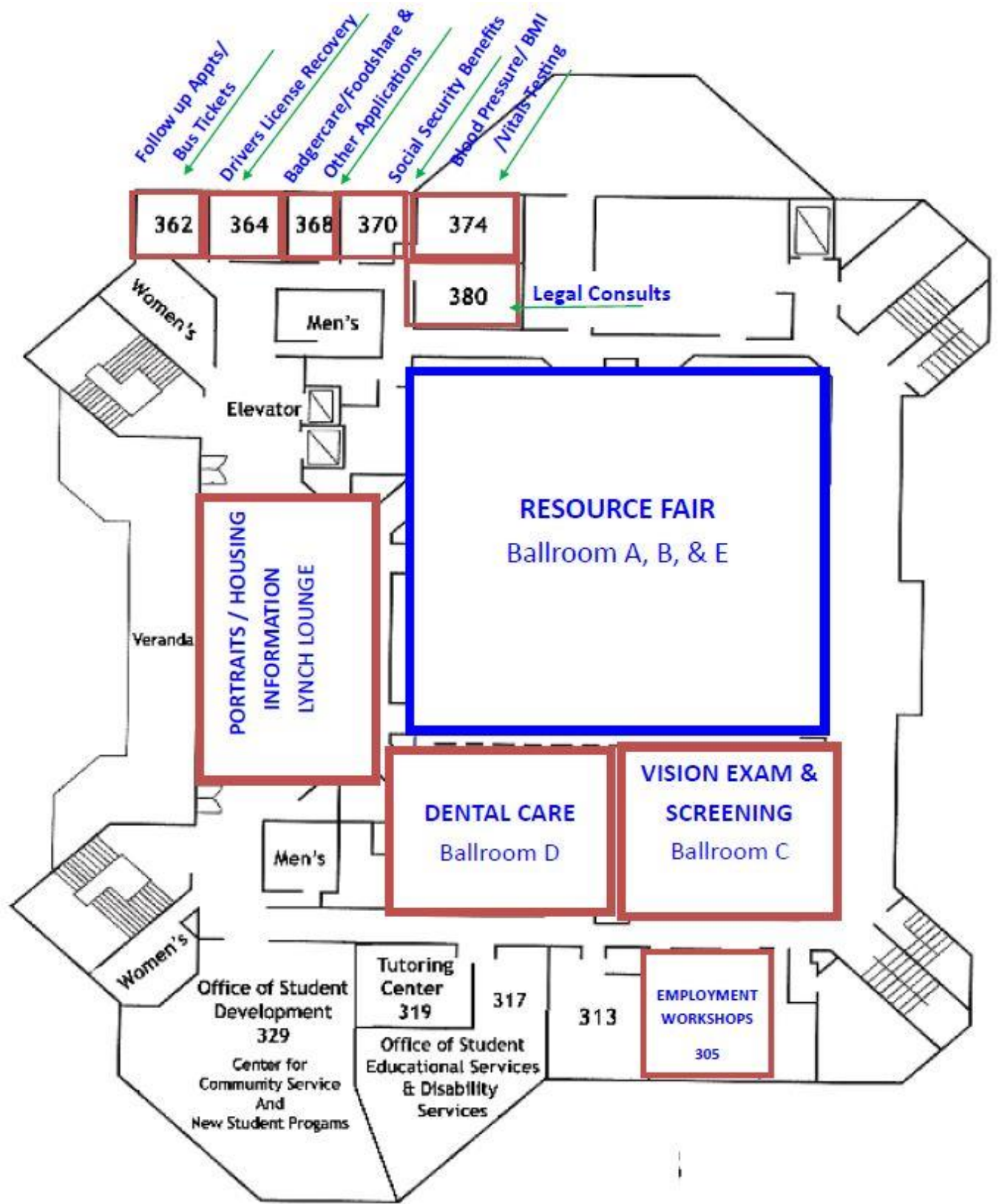

3rd FLOOR

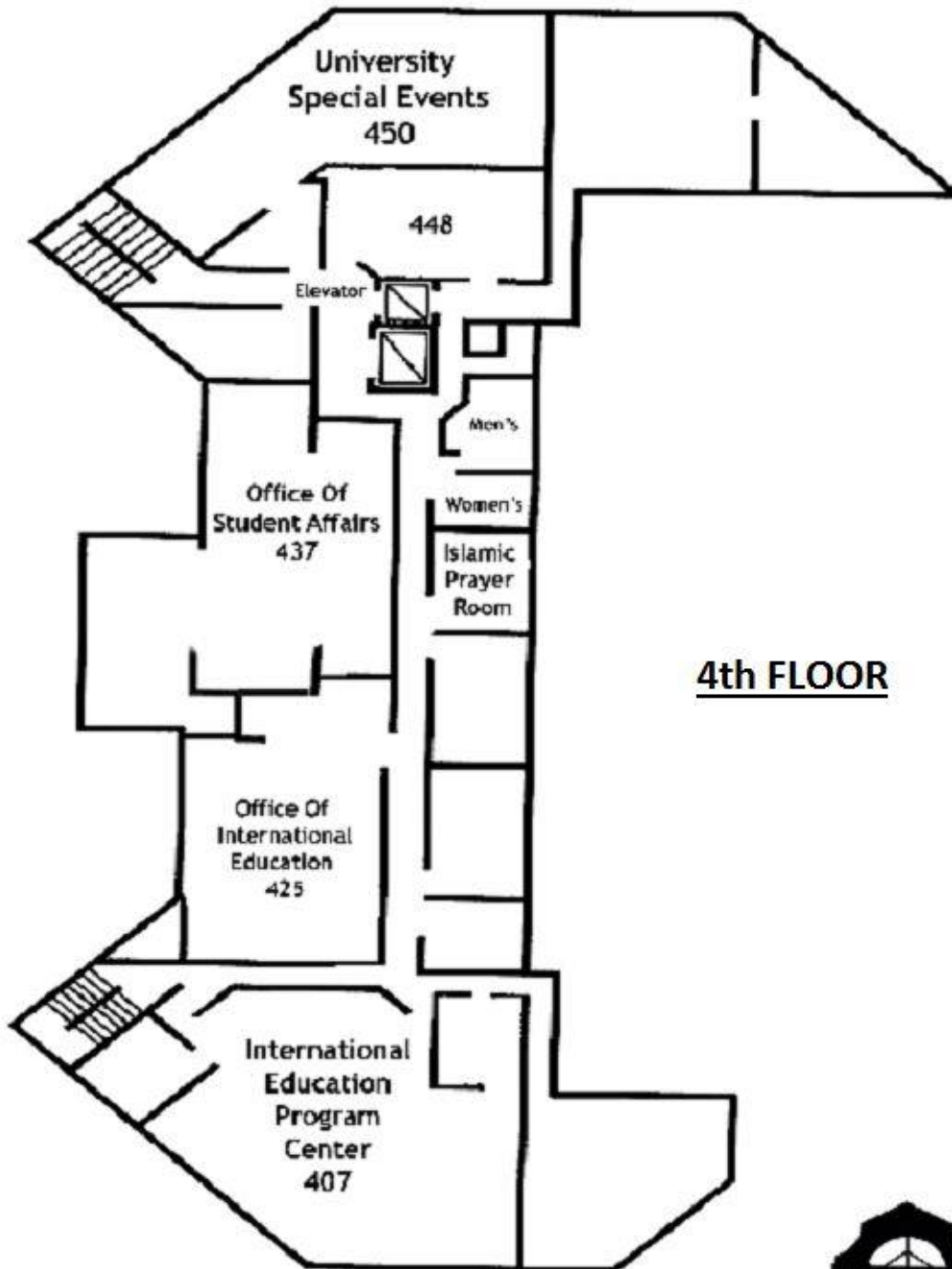

4th FLOOR





SPECIAL THANKS TO OUR 2014 SPONSORS & SUPPORTERS

United Way of Greater Milwaukee

**Marquette University – Alumni
Memorial Union**

United Health Care

Milwaukee County - Housing Division

Walgreens

**City of Milwaukee - Health
Department**

Target

The Salvation Army

Associated Bank

Bowman Systems

Cathedral Center

Downtown BID# 21

Front Room Photography

Help-Portrait Milwaukee

HMO – Managed Health Services

Hupy & Abraham S.C.

**Walker's Point Youth and Family
Center**

Hartford Central Middle School

Kimberly-Clark

**Milwaukee Police Dept. – Homeless
Outreach Team (HOT)**

**Milwaukee Public Schools – Homeless
Education Program**

Outreach Community Health Centers

Sodexo Food Services

U.S. Bank

**Marquette University – School of
Dentistry**

**Marquette University – Career
Services Center**



Marquette University – Public Affairs

VSP Mobile Eyes

City of Milwaukee - Attorney's Office

University of Wisconsin-Milwaukee

The Monarrez Family

The Schoendorf Family

The Kirsch Family

The Nelson Family

St. Ben's Community Meal

103.7 Kiss FM

Stephanie Kirsch—Blessing bags

City Of Milwaukee— Community
Development Grants Administration

With deep gratitude, a final thank you to all the community supporters, service providers, team members, volunteers, and guests who came together to make Project Homeless Connect 2014 a success! The event truly does not exist without each member contributing their energy and support. Thank you for the connections this year and we look forward to making more in 2015!