



# PROJECT HOMELESS CONNECT MILWAUKEE COUNTY

**Marquette Alumni Memorial Union**  
***1442 W. Wisconsin Ave., Milwaukee WI, 53233***  
**Thursday, October 17th, 2013**  
**10:00am - 3:00pm**

A Milwaukee Continuum of Care Event  
[www.milwaukeeecoc.org](http://www.milwaukeeecoc.org)

# Project Homeless Connect: Milwaukee County

**Marquette Alumni Memorial Union  
1442 W. Wisconsin Ave.  
Milwaukee, WI 53233**

**Guests please check in at the Weasler  
Auditorium**

**Thursday, October 17th, 2013**

**Event: 10:00am - 3:00pm**

**Lunch Served from 11:00am-1:15pm**

**Opening speeches by Mayor Tom Barrett,  
Hope House Director Mr. Ken Schmidt,  
and Milwaukee County Supervisor Peggy  
Romo West begin at 10:00**

*The Milwaukee Continuum of Care, as part of the 10 Year Plan to End Homelessness, is excited to present our fourth annual Project Homeless Connect!*

*A special thanks to everyone who was involved and helped to plan this event!*

*Thank you to all of the agencies and service providers who agreed to come and share information, provide services, and desired to be a part of this event.*

*Thanks to all of the volunteers who donated their time to participate in this event. Lastly, thank you to all of the guests who came to this event. We hope it was worth your time and helpful to you.*

# Wondering Where to Go?

## -First Floor AMU

### First Floor Rooms

157 – Hygiene Bank and snack bags

163 – Clothing Bank

Lounge—Birth Certificates

Brooks Lounge 168 - Sleeping bags and lounge for service providers, resource table staff, or volunteers working the event to take a break

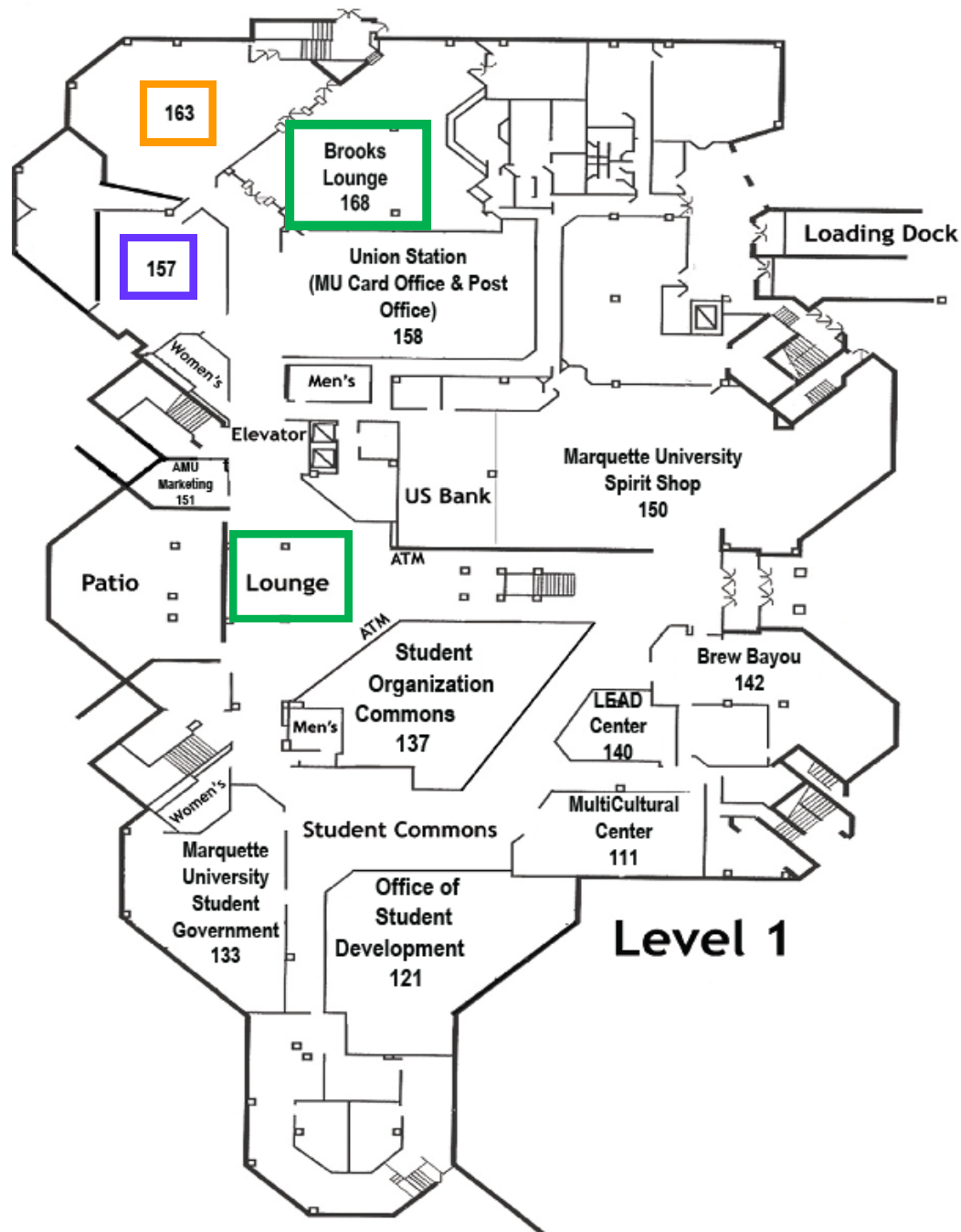

# Wondering Where to Go?

## -Second Floor AMU

### Second Floor Rooms

231 – HIV/STI Testing

254 – Dental Appts, Clinic Info

Westowne Lounge – Volunteer/Agency/  
Provider check-in

228 – PATH Outreach

230 – PATH Outreach (serving people who are  
homeless with mental illness)

252 – Vision Screening

233 – Justice 2000 screenings (if someone has  
tickets/warrants and what they might be able  
to do)

227 – Job Fair

Henke Lounge – Haircuts

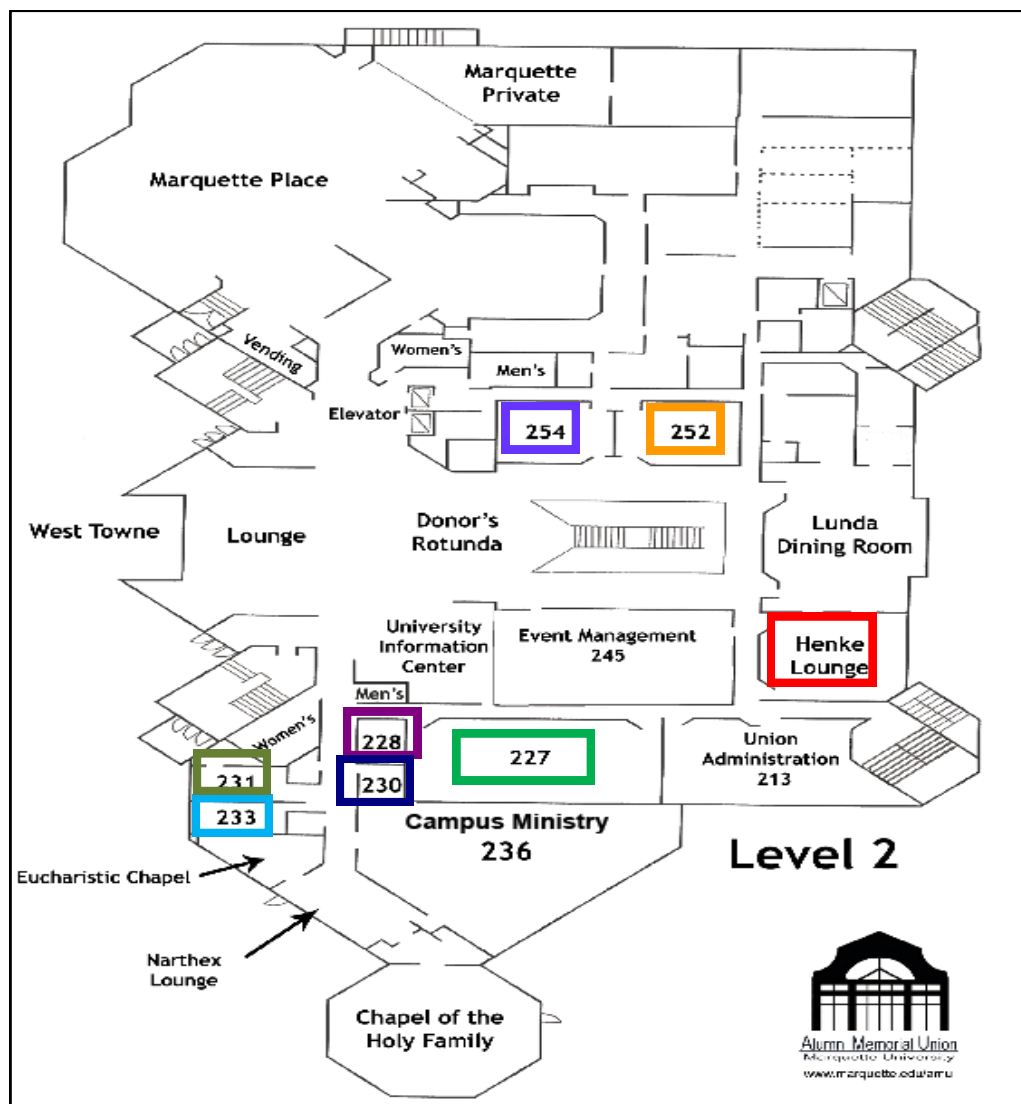

# Wondering Where to Go? Third Floor Rooms

## -Third Floor AMU

Ballrooms A, B and E – Resource Fair

Ballrooms D, and C – Where lunch will be served (11:00am—1:15pm)

Lynch Lounge - Portraits

List of other services on next page

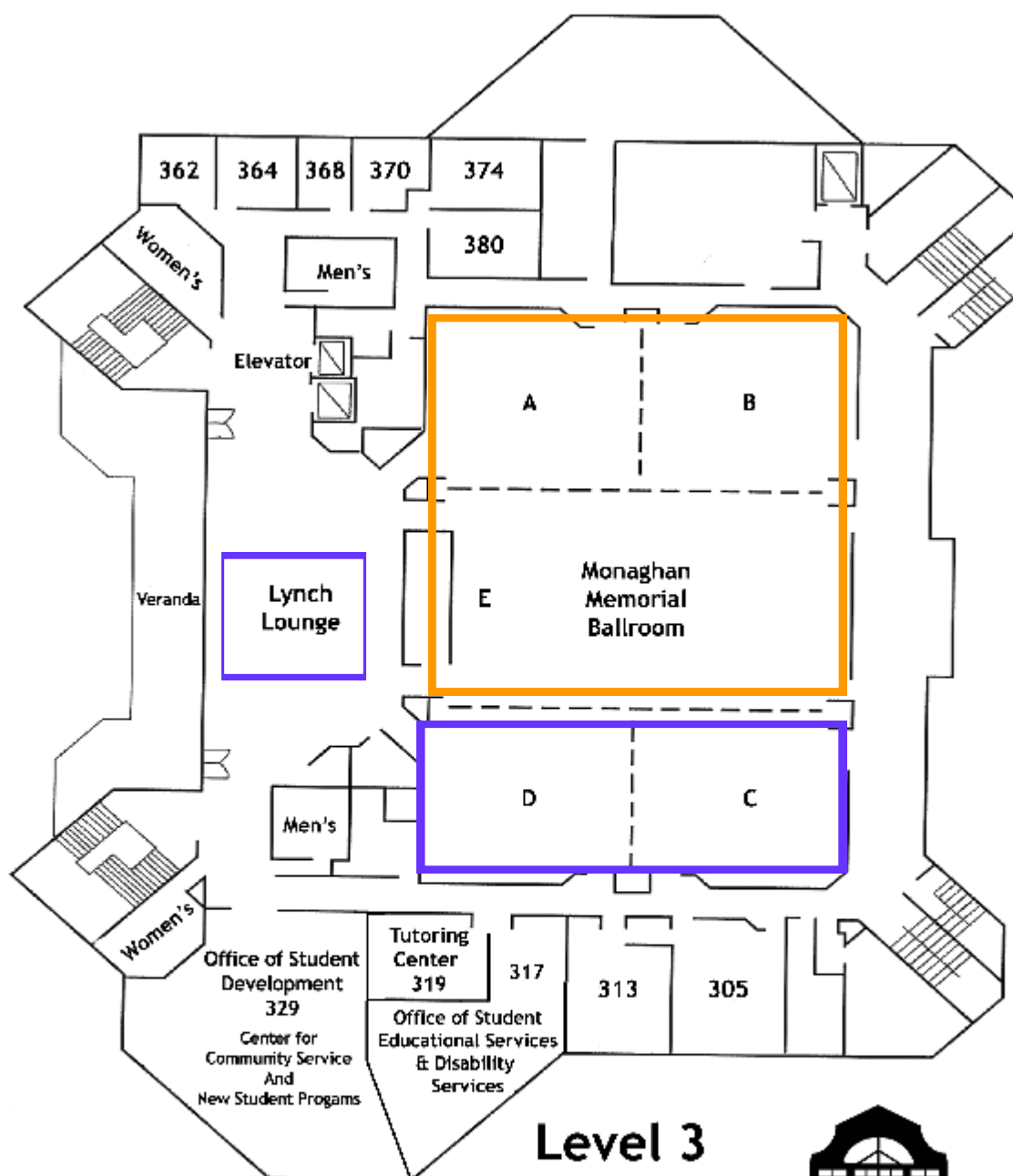

# Wondering Where to Go?

**-Fourth Floor AMU**

**Room 448**—Fleeing Abuse/Domestic  
Violence/Trafficking Guidance

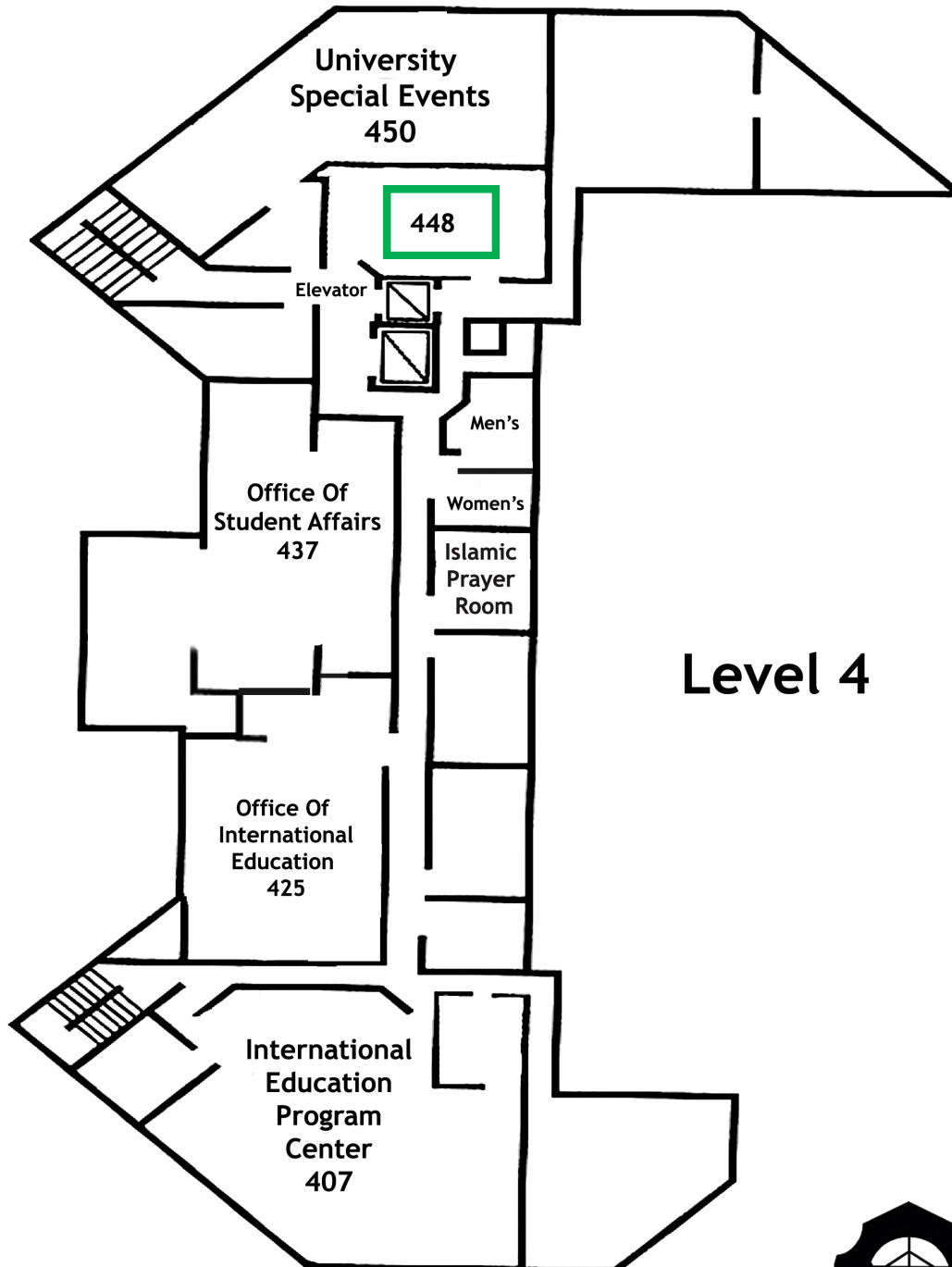

## **Room Assignments for Project Homeless Connect:**

### **Level 1**

157 – Hygiene Bank and snack bags

163 – Clothing Bank

Lounge – Birth Certificate Assistance

Brooks Lounge 168 - Sleeping bags/lounge for service providers, resource table staff, or volunteers working the event to take a break

### **Level 2**

227 - Job Fair

231 – HIV/STI testing

254 – Dental appointments and clinic information

Westowne Lounge – Volunteer and Agency check-in

228 – PATH Outreach (serving people who are homeless with mental illness)

230 – PATH Outreach (serving people who are homeless with mental illness)

252 – Vision Screening

233 – Justice 2000 (assisting people with municipal warrants)

Henke Lounge – Haircuts

### **Level 3**

Ballrooms A, B and E – Resource Fair for homeless services

Ballrooms D, and C – lunch seating (11:00am -1:15pm)

Lynch Lounge – Portraits

362 – IMPACT 211: medical and dental appointments, other referrals

364 – Center for Driver's License Recovery & Employability Program/WI Community Services

368 – Badgercare and FoodShare applications (Health Insurance and FoodStamps)

370 – Social Security status checks and appointments

380 – Legal Consultations - Marquette Law

313 – Employment Workshop – Milwaukee Career Corps

305 – Employment Workshop - YWCA

374 - Health Screenings - Marquette Neighborhood Health Center

### **Level 4**

448 – Fleeing abuse/Domestic Violence/Trafficking Guidance

## Resource Fair Participants—Milwaukee Project Homeless Connect, 2013

- Milwaukee Public Schools
- Hope House
- Milwaukee Women's Center
- Loving Me 1st
- Pathfinders/Streetbeat
- Walker's Point
- VA
- Consumer Credit Counseling
- Community Connect
- Hope Network
- IMPACT 211
- Parenting Network
- WCS (Driver's License Recovery)
- SDC—Agency and Clinic
- SAIL
- Independence First
- Guest House
- St. Vincent de Paul
- Living Proof
- NAMI
- Salvation Army
- Outreach Community Health Centers
- Hunger Task Force
- United Way
- WI Council on Gambling
- Disability Rights/Disability Resource Center
- Justice Point
- Open Door Café
- Milwaukee Public Library
- Meta House
- Grand Avenue Club
- St. Bens
- Sojourner Family Peace Center
- AIDS Resource Center of WI
- WIC
- UMOS
- YWCA
- Automated Health Services
- Black Health Coalition
- 9 to 5
- CVI
- Dry Hootch
- St. Aemilian-Lakeside
- La Causa
- Mental Health America
- VA Regional Office
- Managed Health Services
- Milwaukee LGBT Community Center
- TLS/Crisis Resource Center
- Legal Action
- My Home, Your Home
- The Gathering
- Komen
- Progressive Community Health Centers
- Planned Parenthood
- Career Youth Development
- Safelink—Cell Phones
- Catholic Charities
- Department of Health Services
- Molina Healthcare
- Milwaukee Health Services
- Community Advocates
- Owen's Place
- O'Yeah
- Hupy and Abraham SC
- IMPACT 211 - Coordinated Entry
- Zeidler Center for Public Discussion
- City of Milwaukee - Men's Health Center
- W2/Maximus
- Milwaukee County Disability Services



## **Job Fair Participants**

- YWCA
- Robert Half International-Office Team & Accountemps
- WRTP/Big Step
- Job Center of Wisconsin/Department of Workforce Development
  
- Milwaukee Community Services Corps
- Goodwill Industries of Southeastern Wisconsin
- Job Corps
- Milwaukee Careers Cooperative

## **Service Provider Participants**

- IMPACT 211
- Milwaukee Health Dept HIV/STI Program/CHAPS
- Milwaukee Police Department
- Marquette Neighborhood Health Center
- Milwaukee Careers Cooperative
- Social Security Administration
- Rethink Resources
- Justice 2000
- Milwaukee Portrait Project
- St. Ben's
- Outreach Community Health Centers
- YWCA
  
- Community Advocates Homeless Outreach Nursing Center
- St. Elizabeth Ann Seton Dental Clinic
- WCS/Center for Driver's License Recovery & Employability Program
- Elegance Hair Salon
- US Bank
- Dr. Darwin
- Marquette Law School - Legal Clinic
- The Gathering

# *Special thanks to our donors...*

## **Major Sponsors:**

City of Milwaukee – Community Development Grants  
Administration Milwaukee County – Housing Division  
United Way of Greater Milwaukee  
Associated Bank  
U.S. Bank  
Hupy and Abraham S.C.  
City of Milwaukee – Milwaukee Health Department  
Amalgamated Transit Union – Local 998  
Marquette University – Alumni Memorial Union  
VSP Mobile Eyes  
Bowman Systems  
Milwaukee Public Schools – Homeless Education Program  
Sodexo Food Services  
Milwaukee Police Department – Homeless Outreach Team  
Community Connect  
Walker's Point Youth and Family Center  
Salvation Army  
Hope House of Milwaukee  
Mortenson Construction  
Sodexo  
A. Walker

## **Supporting Sponsors:**

Capuchin Franciscan Ministries  
Career Youth Development  
Cathedral Center Inc.  
City of Milwaukee – City Attorney's  
Office  
Guest House of Milwaukee

Marquette University Dental School  
St. Benedict Community Meal  
The Hacker Family  
Department of Veterans Affairs  
YWCA of Greater Milwaukee  
HMO - Managed Health Services